

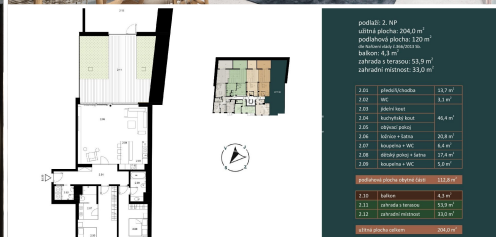

Sale of an apartment 4+kt/B/T, 204 sqm, in the project Garden Lofts, Prague 5 - Pechlátova str.



podlaží: 2. NP	113,0 m ²
užitá plocha: 204,0 m ²	204,0 m ²
podlahová plocha: 120 m ²	120,0 m ²
inženýrská plocha:	
balcon: 4,8 m ²	4,8 m ²
zahradní plocha: 54,9 m ²	54,9 m ²
zahradní výměra: 33,0 m ²	33,0 m ²
2.01 příslušenství	15,7 m ²
2.02 WC	5,1 m ²
2.03 příslušenství	11,2 m ²
2.04 kuchyňská linka	46,4 m ²
2.05 obývací pokoj	20,8 m ²
2.06 ložnice + teras	6,4 m ²
2.07 koupelna + WC	6,4 m ²
2.08 vstupní hala	17,4 m ²
2.09 kuchyňka + WC	5,5 m ²
podlahová plocha včetně balkon	113,0 m²
2.01 + 2.02 + 2.03 + 2.04 + 2.05 + 2.06 + 2.07 + 2.08 + 2.09	204,0 m²

204 m² Pechlátova, Praha 5 Sold



WITH THIS PROPERTY, YOU'LL BE ASSISTED BY

Ing. Zdeněk Jemelík
SENIOR SALES SPECIALIST

zdenek.jemelik@luxent.cz
+420 720 310 300

Order number	GL-06	Price	Sold
Address	Pechlátova, Praha 5	Type	Apartments
Disposition	4 + kitchenette	Usable area	204 m²
Offer status	Sold	Floor area	113 m²
Garden area	54 m²	Low energy	No
Energy performance of the building	B - Very economical	Floor	1st floor
Parking	Yes	Balcony	4 m²
Terrace	Yes	Cellar	Yes
Lift	Yes		

About real estate

We offer for sale a design apartment 4+kk with a living area of 112,8 sqm with a balcony of 4,3 sqm and a garden with a terrace of 53,9 sqm in a unique development project Garden Lofts in Pechlátova street, Prague 5. The apartment is situated on the 1st floor of a new building, the interior includes a hallway, a spacious living room with a kitchenette, two bedrooms, a bathroom with a shower, another bathroom with a bathtub and a separate toilet. From the living area there is access to the terrace with its own garden, from the bedroom to the balcony. In addition, the apartment has a separate garden room (33 sqm) with connection to water, waste and electricity. The apartment has a parking space in the underground garage and a brick cellar.

The order	Layout	Floor	Usable area	Living area	Terrace / Balcony / Loggia	Garden	Price
GL-01	2 + kitchenette	1st floor	55 m ²	51 m ²	No / 4 m ² / No	No	SOLD
GL-02	5 + kitchenette	1st floor	191 m ²	112 m ²	Yes / 3 m ² / No	Yes (44 m ²)	SOLD
GL-03	3 + kitchenette	1st floor	159 m ²	63 m ²	Yes / No / No	Yes (64 m ²)	SOLD
GL-04	2 + kitchenette	1st floor	100 m ²	39 m ²	Yes / No / No	Yes (40 m ²)	SOLD
GL-05	2 + kitchenette	1st floor	110 m ²	39 m ²	Yes / No / No	Yes (40 m ²)	SOLD
GL-06	4 + kitchenette	1st floor	204 m ²	113 m ²	Yes / 4 m ² / No	Yes (54 m ²)	SOLD
GL-07	1 + kitchenette	1st floor	50 m ²	50 m ²	No / No / No	No	SOLD
GL-08	2 + kitchenette	2nd floor	55 m ²	51 m ²	No / 4 m ² / No	No	SOLD
GL-09	4 + kitchenette	2nd floor	117 m ²	106 m ²	No / 3 m ² / 8 m ²	No	SOLD
GL-10	2 + kitchenette	2nd floor	66 m ²	58 m ²	No / No / 8 m ²	No	SOLD
GL-11	1 + kitchenette	2nd floor	39 m ²	39 m ²	No / No / No	No	SOLD
GL-12	1 + kitchenette	2nd floor	40 m ²	40 m ²	No / No / No	No	SOLD
GL-13	3 + kitchenette	2nd floor	119 m ²	109 m ²	No / 4 m ² / 6 m ²	No	SOLD
GL-14	1 + kitchenette	2nd floor	49 m ²	49 m ²	No / No / No	No	SOLD
GL-15	2 + kitchenette	3rd floor	55 m ²	51 m ²	No / 4 m ² / No	No	SOLD
GL-16	4 + kitchenette	3rd floor	116 m ²	106 m ²	No / 2 m ² / 8 m ²	No	SOLD
GL-17	2 + kitchenette	3rd floor	66 m ²	58 m ²	No / No / 8 m ²	No	SOLD
GL-18	2 + kitchenette	3rd floor	67 m ²	67 m ²	No / No / No	No	SOLD
GL-19	3 + kitchenette	3rd floor	111 m ²	101 m ²	No / 4 m ² / 6 m ²	No	SOLD
GL-20	2 + kitchenette	3rd floor	53 m ²	53 m ²	No / No / No	No	SOLD
GL-21	3 + kitchenette	4th floor	165 m ²	112 m ²	53 m ² / No / No	No	SOLD
GL-22	4 + kitchenette	4th floor	191 m ²	132 m ²	59 m ² / No / No	No	SOLD
GL-K1	Bussiness Units	ground floor	99 m ²	99 m ²	No / No / No	No	11 950 000 CZK
GL-K2	Offices	ground floor	100 m ²	100 m ²	No / No / No	No	11 990 000 CZK