

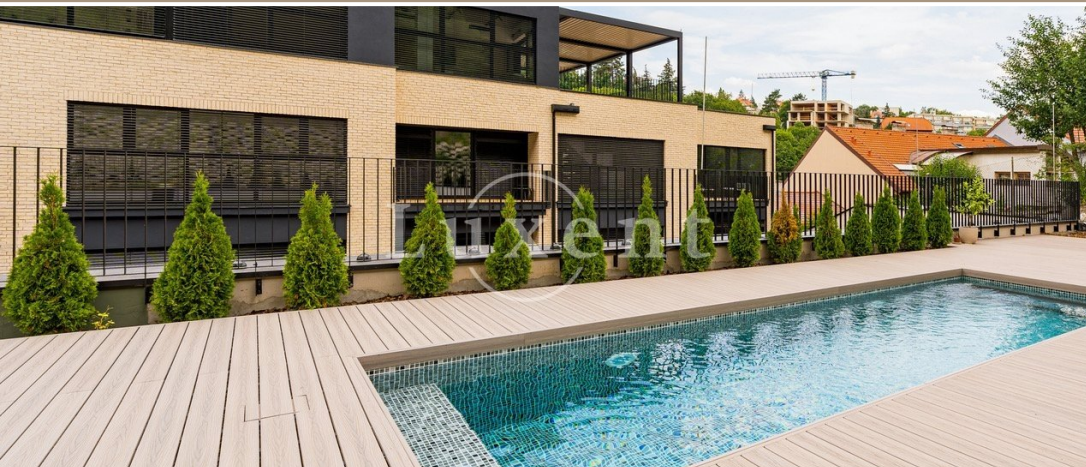

For sale a design apartment 1+kt, 53,8 sqm, Prague 5 - Radlice



🏠 54 m<sup>2</sup> 📄 Pechlátova, Praha 5 - Radlice 💰 10 990 000 CZK per property



WITH THIS PROPERTY, YOU'LL BE ASSISTED BY

**Romana Čermáková**

EXTERNAL SALES SPECIALIST

romana.cermakova@luxent.cz

+420 770 181 181

Order number	<b>N7132</b>	Price	<b>10 990 000 CZK per property</b>
Address	<b>Pechlátova, Praha 5 - Radlice</b>	Type	<b>Apartments</b>
Disposition	<b>1 + kitchenette</b>	Usable area	<b>54 m<sup>2</sup></b>
Low energy	<b>No</b>	Energy performance of the building	<b>G - Extremely uneconomical</b>
Floor	<b>2nd floor</b>	Device	<b>Yes</b>
Parking	<b>Yes</b>	Lift	<b>Yes</b>

## About real estate

We offer for sale a new, completely and aesthetically furnished apartment 1+kt, in the exclusive Residence Garden Lofts. The apartment unit with a total floor area of 53.8 sqm is located on the 3rd floor of a new building with elevator and part of this exceptional residence is a garden with an outdoor pool.

The layout of the modern industrial apartment includes a hallway, a spacious and airy living room with a fully equipped kitchenette with all appliances and an imaginatively separated area that is used as a bedroom. The spacious bathroom includes a shower, toilet and there is a washing machine and dryer. The apartment uses high quality and design elements, wooden floors, underfloor heating, sight concrete. The apartment has a SMART Home system for home management.

The Garden Lofts residence is a unique apartment building characterized by industrial style and timeless interior and exterior design. The residence includes a terraced south-facing garden that offers a variety of uses, including an outdoor pool.

Garden Lofts is located in Prague 5 - Radlice, where you will find complete civic amenities, excellent transport accessibility, as well as living near the nature reserves Dívčí hrady, Vidoule or Prokopské údolí.

The surrounding area offers a number of shops, restaurants, entertainment centres or you can drive to the Smíchov shopping centre or Galerie Butovice in a few minutes. Within walking distance of the tram connection, metro station B - Radlická.