

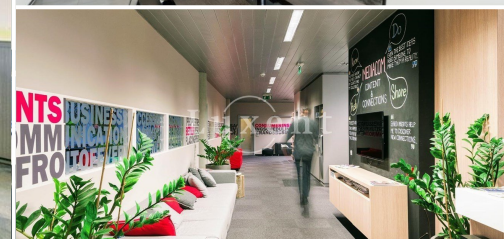

An office space for rent 239 sqm, Prague 5 - Smichov

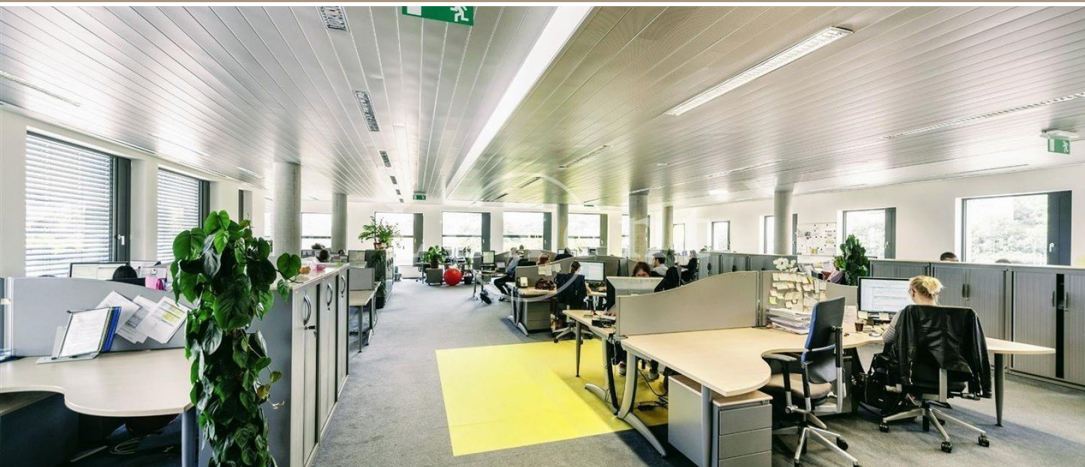

🏠 239 m² 📄 Nádražní, Praha 5 - Smíchov 🏠 435 CZK per m² / month



WITH THIS PROPERTY, YOU'LL BE ASSISTED BY

Filip Sloupenský

COMMERCIAL LEASE SPECIALIST

filip.sloupensky@luxent.cz

+420 771 229 229

Order number	FOC-2	Price	435 CZK per m² / month + services
Address	Nádražní, Praha 5 - Smíchov	Type	Offices
Usable area	239 m²	Parking	No
Low energy	No	Energy performance of the building	G - Extremely uneconomical
Floor	5th floor	Device	Partly
Lift	Yes		

About real estate

We offer for lease office space of 239 sqm in a business complex in Prague 5, which boasts convenient and flexible accessibility thanks to the access road to Jižní Spojka and the possibility of urban and suburban transport. The office building complex is located above the entrance to the metro station B - Smíchovské nádraží, close to the metro station Anděl. There are also other units up to 1,128 m² for rent in the building. Terraces with magnificent views are an integral part of the building.

The complex has a central reception, security, magnetic card access, opening windows with electric blinds, air conditioning, double floors, wheelchair access throughout the building, gym and offers unlimited access and flexible space solutions according to the tenant's needs. The building has ample parking spaces. Energy performance of the building - A.

The location offers numerous shops, swimming pool, cafes and other services. All civic amenities will be provided by the nearby Anděl - Nový Smíchov shopping centre.

Services: 140 CZK/sqm/month.

Price for reserved parking space: 110 EUR/month.

Available immediately. For more information contact the broker.